

- 1 Remove the screw from the bottom of the pin. Place the screw through the desired pin hole on the base and tighten the pin until secure.

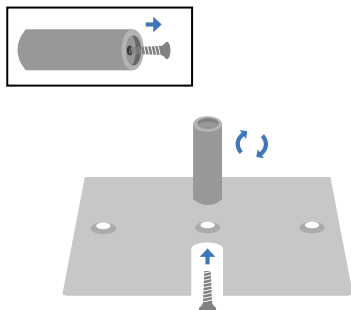

- 2 Connect the 8' upright by sliding the two pipes together to make one pipe 8ft high. You should have slots at 3ft and the CastleTop[®] at the top of the upright when connected.

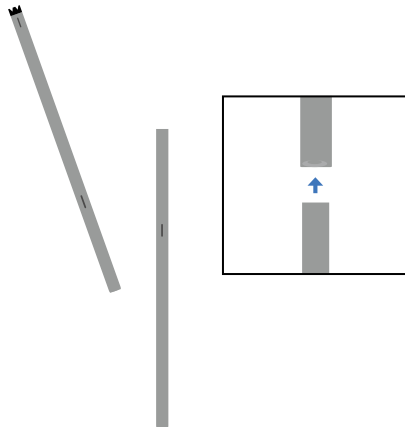

- 3 Place the Upright over the pin.

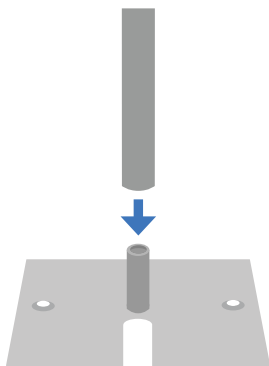

- 4 Insert the two hook-end pieces of the horizontal Drape Support into the middle pipe with the button holes. Adjust to your desired width. (Typical set-ups are 10ft wide)



- 5** String drape onto the Drape Support before hanging.

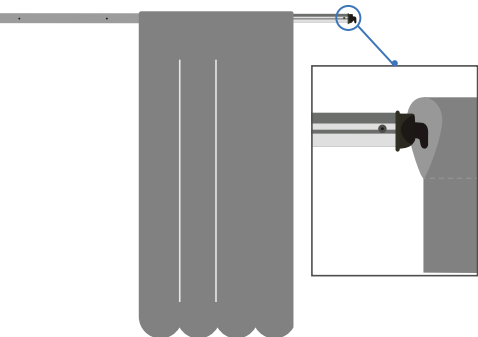

- 6** Attach each Hook End of the Drape Support to the CastleTop[®] at the top of the Upright.

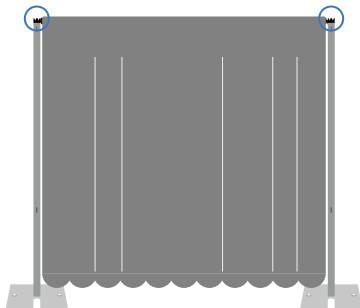

Finished Look!



Set Up Video

